

# Cranchi Panama 29



## General Particulars

Length Overall (without engine)	8.60 m	Fuel Oil Tank	340 L
Length Hull	7.51 m	Fresh Water Tank	100 L
Beam	3.24 m	Draft (incl. propellers)	1.0 m
Dry weight (without engine, approx.)	3,300 kg	Max. passengers	8 men

# Cranchi Panama 29

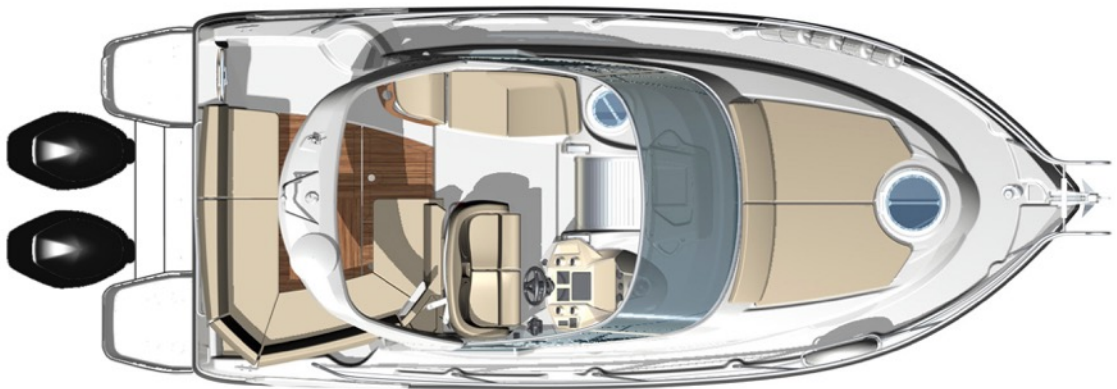
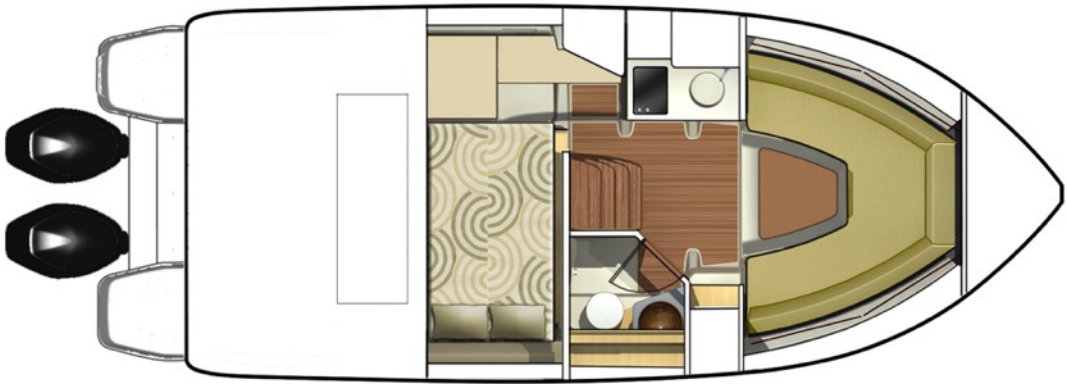

# Cranchi Panama 29

## Equipment List

Bilge micro suction system

Waste water tank

Hood

Hydraulic trim tabs with position indicator

Bow sunbathing cushion plus cover

Bow thruster with automatic fire extinguisher

G.P.S. + colour chart plotter Garmin

220V Electric Wiring System with battery charger, electrical resistance on water heater and shore power 32Ah with cable

6 Nos. fenders + fender covers

Radio Cd/Mp3 + Dvd

Teak cockpit table convertible in sunbathing + cushion

Folding saloon table convertible into bed

Cockpit cover

Electric anchor winch 500W - 30 m chain – anchor 10 kg

Water distribution system directly from the dock

Roll-up foldaway hoses

Grey water: shower collection system

Acoustic and visual alarm on the dashboard for water in the bilge

Electric engine room hatch

Engine/on-board service batteries 2 nos.

Magnetic compass

Anti-flammable blanket

# Cranchi Panama 29

## Equipment List

Cockpit shower + WC shower

Fire extinguisher: 2 nos. automatic in engine room + 1 nos. manual in the cockpit

Cabin fridge 65L

Boat hook

**For purchase enquiries, please email  
[commercial@marine-commerce.com](mailto:commercial@marine-commerce.com)**



Marine Commerce Private Limited  
No. 38 Jalan Pemimpin, #08-03,  
Singapore 577178 Tel: +65 6744 5040